

THE LATE MINOAN IIIB:1 SETTLEMENT

STRATIGRAPHY AND CATALOGUES

STREET BETWEEN BUILDINGS 1 AND 3

STREET BETWEEN BUILDINGS 1 AND 3 (Figs. 51, 52a-b, Pls. 16c:19, 27, 21b:21, 25, 27, 54c-56a)

Between the Buildings 1 and 3 runs a street with a width of 1.1 (southwest) to 1.5 (northeast). This street, like the neighbouring buildings, seems to belong entirely within the LM IIIB:1 period and it has been heavily disturbed both during the Minoan and later periods for which reason only a few fragments of floors are preserved.

The street appears to have had three surfaces during its period of function. They were all sloping from east to west. In the eastern part only one floor level was noted, 13-Floor 5, which may also have coexisted with 13-Floor 2 when the western part of the street was raised. The original floor, 13-Floor 7a, was only noted in the western part. In the eastern part it had been cut through by rubbish pits upon which 13-Floor 5 was laid.

The upper surface of the street probably also functioned into the LM IIIB:2 period as indicated by deposits going down to the surface of the latest LM IIIB:1 street level, 13-Floor 2 in the western part.

In upper layer (Figs. 51, 52a-b, Pls. 54c-d, 55a)

This consisted of two fragments excavated in 1977 and 1982 respectively. The eastern fragment (13-Floor 5) excavated at levels 9.94 to 9.80, was yellowish-brown with a great concentration of pebbles and was rather soft, while in the western part, 13-Floor 2, excavated at levels from 9.91 to 9.75, the floor was more greyish. Several sherds and bones were noted in the floor and many small stones were found immediately below the floor. Below the floor was noted a thin layer of soft, yellowish-red, very sandy soil. LM IIIB and some LM IIIA was noted everywhere. 9.120 kg of pottery were collected: 21% decorated, 53% kept and 1.8% inventoried. Shapes were not counted.

POTTERY

77-P 0936, Pl. 170e:5

Cup, body frg. Clay: LW. Scar from a vertical, strap handle. Int. sponge pattern. Ext. a flower, three body bands and a band around handle attachment. Th. 0.002-3. LM IIIA:2.

77-P 0937, Pl. 170e:12

Kylix, stem/foot frg. Clay: red. Plain ware. Hollowed stem. Stem Ø 0.022. Foot Ø 0.08. Th. 0.008. Burnt. LM IIIB:1.

77-P 0938, Pl. 170e:10

Kalathos, rim frg. Clay: red. Yellow slip and red paint. Everted rim, flat on top, a complete high-slung oval handle on rim. Int and ext RB. Bands along edges of handle and barred on top. Handle 0.020 × 0.028. Th. 0.007. LM IIIB:1.

77-P 1597, Pl. 170e:11

Stirrup jar, large, false neck/disc frg. Clay: light red. Beg. of both handles. Ext. a spiral on top of disc and neck band. Disc Ø 0.057. LM IIIA:2/B:1.

82-P 1365, Pl. 170e:3

Kylix, rim/handle frg. Clay: LW. Part of a high-slung oval handle (loop-handled). Ext. handle monochrome on top. Handle 0.008 × 0.015. LM IIIA:2.

82-P 1366, Pl. 170e:2

Cup, rim frg. Clay: LW. Slightly marked rim. Int. RB. Ext. RB, concentric semicircles and chevrons?. Th. 0.003-4. LM IIIB:1.

82-P 1367, Pl. 170e:4

Stirrup jar, small, body frg. Clay: light brown. Scar from a spout. Ext. a band around spout, a spiral and three even body bands. Th. 0.003-7. LM IIIB:1.

82-P 1368, Pl. 170e:7

Amphora, rim/base frg. Clay: light brown to slightly grey. Straight rim, flat on top, beg. of a vertical, oval handle, flat, slightly splaying, base. Ext. broad base band and a thin band above. Rim Ø est. 0.10. Base Ø est. 0.082. Handle 0.024 × 0.035. Th. 0.008-11. LM IIIA:2/B:1.

82-P 1369, Pl. 170e:8

Stirrup jar, large, false neck frg. Clay: red. Scar from a handle. Ext. covered with cream slip. Neck Ø est. 0.045. Disc Ø est. 0.07. Th. 0.008-11. LM IIIA:2/B:1.

82-P 1370, Pl. 170e:1

Krater, foot frg. Clay: light reddish-brown. Low ring foot. Int. faint traces of paint, monochrome? Ext. base band. Foot Ø est. 0.07. Th. 0.005-7. LM IIIA:2/B:1.

82-P 1516, Pl. 170e:6

Cup, rim frg. Clay: light red. High, flaring rim. Int. and ext. RB, a row of dots and spirals? Th. 0.004. LM IIIA:1.

82-P 1517, Pl. 170e:9

Open vessel, body frg. Clay: greyish-white. A low ridge. Int. RB? Ext. monochrome. Th. 0.004-6. LM IIIA:2/B:1.

SMALL FINDS

77-M 039, Pl. 244d, 526.45/701.3/9.86 [329]

Bronze razor?, frg. Chipped along sides. Light-green corrosion. Of an elongated shape, rounded at one end, pointed at other end. One long-side a bit more curved than other long-side. L 0.027.

BONES

Some fragments from young and adult *Ovis*, *Ovis/Capra*, *Sus*, and *Bos*; also from adult *Capra* and *Dama*.

In middle layer (Figs. 51, 52a-b, Pls. 55b)

Two deposits are described here: the floor with its possible packing, and a large rubbish area in the eastern part which had destroyed the lower street floor (13-Floor 7a) and therefore stratigraphically must be younger than that floor.

13-Floor 5, excavated at levels 9.83/9.74 to 9.72/9.58, is greyish with many small pebbles, sherds and bones trodden into the surface. In the northern part from 523.5 to c. 524.3 two slab stones were noted (Pl. 55b). Immediately below the surface it becomes red-brown, sandy with some bits of charcoal. Below the floor was a soft, sandy, light greyish-brown layer with a lot of ash in parts, bits of charcoal and small stones. This part of the street was only partly preserved from c. 522 to 524.3.

The rubbish pit was excavated as two different pits on each side of a Venetian wall that destroyed the pit, but soil descriptions, stratigraphical position, and levels (from below floor-packing to c. 9.24) strongly indicate that they were part of the same pit, for which reason they have here been treated as one. The very western part of this pit was destroyed by a Venetian pit (GSE I, 142-143), Fig. 52a. In the eastern part the soil is simply described as soft brown with a few small stones while in the western part (Pl. 21b:25) it is described as soft, yellowish-brown, sandy soil with some small stones and bits of charcoal. In the eastern part the rubbish pit extended both east and north of the preserved part of 13-Floor 5, but not below the walls. Neither did the western part of this deposit go below the walls of the street, although the bottom was found at a level which was little lower than the bottom of 13-Wall 2. In the very southwestern part a small hard deposit was noted at level 9.35, reminiscent of a street surface. The rubbish pit should probably be connected to the large Rubbish Area Southeast.

In and immediately below the floors LM IIIB was noted and some earlier sherds, while the rubbish pit below contained mainly LM IIIA and B with a few earlier pieces, while a few intrusive later sherds were also noted. 56.935 kg of pottery were collected: 19% decorated, 56% kept and 2.0% inventoried. Shapes were not counted.

POTTERY

In and immediately below:

77-P 0524, Pl. 171a:2

Amphoroid krater, body frg. Clay: LW. Ext. an octopus with dots above head. Th. 0.008. LM IIIB:1.

77-P 0537, Pls. 95, 171a:1

Kylix, rim/body frgs. Clay: light yellowish-red with grey core. Slightly everted rim. Int. RB. Ext. RB and two thin bands between two broader. Rim Ø est. 0.18. Th. 0.005. Misfired. LM IIIB:1.

77-P 0539, Pl. 171a:4

Stirrup jar, large, disc frg. Clay: light brownish-grey. Ext. bands along edges and a cross. Th. 0.005. LM IIIA:2/B:1.

77-P 1941/82-P 1606, Pl. 171a:5

Rhyton, conical, body frgs. Clay: LW. Ext. one thin, a broad and four thin body bands. Ø est. 0.072-0.046. Th. 0.008-10. Burnt. LM IIIA:2/B:1.

77-P 1942, Pl. 171a:3

Lamp, handle frg. Clay: red. Plain ware. End part of a flat/oval handle roughly rounded at the end, one suspension hole. Handle 0.019 × 0.024. LM IIIA:2/B:1.

82-P 1538, Pl. 170f:2

Amphoroid krater, handle frg. Clay: light brown. Part of a broad, strap handle. Ext. band along edge and chevrons on top. Th. 0.012. LM IIIA:2.

82-P 1539, Pl. 170f:1

Cup, rim frg. Clay: light brown. Everted rim. Int. RB. Ext. RB and concentric semicircles. Rim Ø est. 0.12. Th. 0.003. LM IIIA:2/B:1.

82-P 1540, Pls. 111, 170f:3

Minoan flask, body frg. from central disc. Clay: light brownish-grey. Ext. iris cross? on central disc framed by three circular bands and a further band. Th. 0.005-6. LM IIIA:2.

82-P 1541, Pl. 170f:4

Kylix, stem/foot frg. Clay: light brown. Plain ware. Hollowed stem. Stem Ø 0.027. Foot Ø est. 0.14. LM IIIB:1.

82-P 1605 (+77-P 0184; 77-P 0345), Pls. 110, 170f:8

Rhyton, conical, full profile. Clay: LW. Everted rim, flat on top, a low ridge c. 0.015 below rim. Ext. filled semicircles on top of rim, broad RB a band below, panelled pattern: horiz. wavy bands framed by two vertical bands and vertical wavy border. Two thin and a broad body band. Rim Ø est. 0.12. Th. 0.005-8. LM IIIB:1.

82-P 1607, Pl. 170f:7

Bowl, body frg. Clay: light reddish-brown. Int. monochrome. Ext. a hatched lozenge and a body band. Th. 0.004-5. LM IIIB:1.

82-P 1608, Pl. 170f:5

Stemmed bowl, rim frg. Clay: light red with buff core, hard, fine. Short, rounded lip, a groove below, scar from a horiz. handle. Int. and ext. monochrome red. Th. 0.003-5. Myc IMP. FS 305. LH IIIB:1.

82-P 1609, Pl. 170f:6

Tankard, spout frg. Clay: red. Part of an open spout. Ext. bands along edges int. and ext. Th. 0.005-6. LM IIIB:1.

82-P 1610, Pls. 119, 170f:9

Tripod cooking pot, rim frg. Clay: reddish-brown with grey core. Coarse fabric. High, flaring rim. Rim Ø est. 0.28-30. Th. 0.009-10. LM IIIA:2/B:1.

SMALL FINDS

77-S 018, Pls. 224, 244e, 524.00/700.50/9.70 [330]

Rock crystal, completely pres., only slightly chipped at top. Worked into a prism-shape. Underside is rough and does not seem to have been worked. H 0.027. Ø at base 0.038. Cf. 77-S 019, below p. 121.

SHELLS

1 *Patella* – broken centre. 4 *Spondylus* – upper: hinge W 0.0245, fresh; lower: hinge W 0.034, fresh; one upper, one lower, two fresh, 2 MNI.

Rubbish pit below:

77-P 0296, Pl. 171b:11

Cup, rim frg. Clay: light brown. Everted rim. Int. RB. Ext. RB and irregular wavy bands? Rim Ø est. 0.12. Th. 0.004. LM IIIA:2/B:1.

77-P 0297, Pl. 171b:10

Kylix, upper stem frg. Clay: light red with light brown core. Hollowed stem. Ext. thin and broad bands. Stem Ø 0.034 (not middle) LM IIIB:1.

77-P 0298 (+77-P 1603), Pls. 95, 171b:2

Bowl, rim/body frgs. Clay: light brown. Slightly marked rim, part of two horiz., roll handles. Int. monochrome. Ext. RB, isolated spirals and three thin body bands between two broader. Bands along edges of handle and bars on top, a band around handle section. Rim Ø est. 0.15. Th. 0.003-5. LM IIIB:1.

77-P 0299, Pl. 171b:6

Cup, rim frg. Clay: LW. Everted rim. Int. RB. Ext. RB and a flower. Rim Ø est. 0.16. Th. 0.004. LM IIIA:2/B:1.

77-P 0300, Pl. 171b:9

Bowl, base/body frg. Clay: light brown. Flat base. Int. a large spiral at base. Ext. base band and a thin band above. Base Ø 0.04. Th. 0.003-6. LM IIIB:1.

77-P 0301 (+82-P 0171), Pl. 171b:4

Cup, rim/body frgs. Clay: brown. Everted rim, pulled out for a rough spout. Int. RB. Ext. RB, tricurved arcs and two body bands pres. Th. 0.003. LM IIIA:2/B:1.

- 77-P 0302, *Pl. 171b:5*
Bowl, rim frag. Clay: LW. Slightly marked rim. Int. RB. Ext. RB and a flower? Rim Ø est. 0.16. Th. 0.004. LM IIIB:1.
- 77-P 0303 (+77-P 1618), *Pls. 91, 171b:1*
Cup, rim/body frgs. Clay: LW. Straight rim. Int. RB. Ext. RB, concentric semicircles and three body bands. Rim Ø est. 0.14. Th. 0.004. LM IIIB:1.
- 77-P 0304, *Pl. 171b:7*
Cup, rim frag. Clay: light red. Yellow slip and reddish-brown paint. Everted rim. Int. RB. ext. RB and a flower. Rim Ø est. 0.14. Th. 0.003. LM IIIA:2/B:1.
- 77-P 0388 (+71-P 0388), *Pls. 92, 171c:1*
Cup, rim/body frgs. Clay: LW. Lugged rim pulled out to form a rough spout. Int. RB and sponge pattern. Ext. RB, rows of irises, dots, quirk, dots and three body bands. Rim Ø est. 0.13. Th. 0.002-3. LM IIIA:2.
- 77-P 0389, *Pls. 93, 171c:15*
Footed cup, two-handled, lower body and stem frag. Clay: LW. Int. a band around base. Ext. monochrome stem, a band above. Stem Ø 0.027. Th. 0.007-10. Burnt. LM IIIB:1.
- 77-P 0390, *Pl. 171c:7*
Cup, rim frag. Clay: brown. Everted rim. Int. RB. Ext. a blob? and four body bands. Th. 0.004. LM IIIA:2/B:1.
- 77-P 0391, *Pls. 105, 171e:1*
Amphora, rim/neck body frag. Clay: light brown. Everted, rounded rim, one complete, vertical, oval handle pres. Int. RB. Ext. RB, a wavy band on upper body and two body bands pres. Band along top of handle. Rim Ø est. 0.096. Handle 0.020 × 0.028. Th. 0.007. LM IIIB:1.
- 77-P 0392, *Pl. 171e:4*
Storage jar, body frag. Clay: light reddish-brown. Ext. filled circle with radiating strokes and a curved band. Th. 0.014. LM IIIA:2/B:1.
- 77-P 0393, *Pls. 93, 171c:9*
Cup, miniature, rim frag. Clay: light brown. Straight rim. Int. monochrome. Ext. RB, a row of irises and a body band. Rim Ø est. 0.08. Th. 0.003. LM IIIB:1.
- 77-P 0454, *Pl. 171c:2*
Cup, rim frag. Clay: LW. Everted rim. Int. RB. Ext. RB and alternating arcs. Th. 0.004. LM IIIA:2/B:1.
- 77-P 0455, *Pls. 96, 171c:5*
Kylix, rim/body frag. Clay: LW. Everted, rounded rim. Int. RB. Ext. RB and hatched triangles and ovals? Rim Ø est. 0.17. Th. 0.003. LM IIIB:1.
- 77-P 0529, *Pl. 171d:9*
Rhyton, conical, body frag. Clay: cream. Ext. horiz. rows of filled triangles framed by bands. Ø est. 0.048-0.040. Th. 0.008. LM IIIA:2/B:1.
- 77-P 0530, *Pls. 110, 171d:2*
Rhyton, wide-mouthed, spout. Clay: LW. Ext. monochrome spout, a band above. Spout Ø 0.012. Th. 0.003-4. LM IIIA:2/B:1.
- 77-P 0531, *Pl. 171d:3*
Rhyton, wide-mouthed, spout. Clay: light brown. Ext. monochrome spout and a band above. Spout Ø 0.013. Th. 0.004. LM IIIA:2/B:1.
- 77-P 0957, *Pl. 171d:1*
Cup, body frag. Clay: light greyish-brown. Scar from a vertical, strap handle. Int. a band close to base. Ext. chevrons and multiple arcs, three body bands and a band around handle attachment. Th. 0.003-4. LM IIIA:2/B:1.
- 77-P 0973, *Pl. 171f:3*
Closed vessel, body frag. Clay: LW. Ext. network with hatched lozenges. Th. 0.005. Burnt. LM IIIA:2/B:1.
- 77-P 0982, *Pl. 171c:14*
Kylix, lower body and stem frag. Clay: buff, hard, fine. Base with a low dome underneath. Int. and ext. monochrome black. Stem Ø 0.023. Th. 0.004-5. Myc IMP. FS 264. LH IIIA/B:1.
- 77-P 1378, *Pl. 216a:4*
Pithos, four body frgs. with part of a vertical handle. Gravel-tempered fabric. Handle is ovoid in section with no swellings on the int. face (pres. L 0.063; W 0.035). Several neighbouring horiz. rfb (surface covering) with crescent-shaped impressions, some regular others irregular (2A). Rfb interrupted by horiz. handle. Th. 0.020-16. W of rfb 0.027-30. MpL 0.26. Sec. burnt all over. Perhaps the same as 77-P 1678 (above, p. 50). LM III.
- 77-P 1555, *Pl. 171d:5*
Kylix, stem/foot frag. Clay: LW. Hollowed stem. Ext. broad band at stem, a band below and a band along edge of foot. Stem Ø 0.021. Foot Ø est. 0.10. LM IIIB:1.
- 77-P 1557, *Pl. 171f:5*
Kylix, rim/body frag. Clay: LW. Plain ware. Everted rim, a complete, vertical, strap handle. Rim Ø est. 0.16. Handle 0.004 × 0.018. Th. 0.003-4. LM IIIB:1.
- 77-P 1563, *Pl. 171f:6*
Lid, full profile. Clay: cream. Coarse fabric. Flanged lid. H 0.052. Rim Ø 0.142. Ø on top 0.14. Th. 0.006. LM IIIA:2/B:1.
- 77-P 1595, *Pl. 171d:4*
Kylix, stem frag. Clay: LW. Hollowed stem. Ext. stem completely covered except for two thin reserved band at top. Stem Ø 0.027. LM IIIB:1.
- 77-P 1658, *Pl. 171f:2*
Closed vessel, upper body frag. Clay: light greyish-brown. Ext. neck band, two wavy bands, chevrons and two wavy bands below. Th. 0.009. LM IIIA:2/B:1.
- 77-P 1662, *Pl. 171f:1*
Stirrup jar, large, upper body frag. Clay: reddish-brown to grey. Part of a vertical, strap handle, scar from spout and false neck. Ext. band around handle, spout and false neck, a flower and two body bands. Handle 0.012 × 0.025. Th. 0.005-7. LM IIIA:2/B:1.
- 77-P 1667, *Pl. 171d:7*
Amphoroid krater, body frag. Clay: LW. Ext. zigzag with irises framed by wavy bands and two body bands. Th. 0.007-8. LM IIIA:2/B:1.
- 77-P 1669 (+82-P 0706), *Pls. 104, 171d:6*
Jug (ewer), rim/neck frag. Clay: greyish-brown. Everted rim, flat on top somewhat sloping ext. Scar from a strap, vertical handle. Int. monochrome. Filled semicircles on top of rim. Ext. a thin and a broad band, a row of S's framed by two thin bands. Rim Ø est. 0.12. Th. 0.007. LM IIIA:2.
- 77-P 1670, *Pl. 171f:4*
Closed vessel, body frag. Clay: light brown. Ext. running spirals. Th. 0.004-5. LM IIIA:2.
- 77-P 1697, *Pl. 215f:17*
Pithos, body frag. Gravel-tempered fabric. Horiz. neighbouring rfb, surface covering, with crescent-shaped impressions (2A). Th. 0.013-17. W of rfb 0.028. MpL 0.112. Rfb damaged. Perhaps the same as 78-P 0088 (Vol. V) and 78-P 0494 (GSE II, 59). LM III.
- 77-P 1705, *Pl. 171c:10*
Closed vessel, body frag. Clay: reddish-brown. Ext. four, slightly curved, vertical bands and a body band. Max. body Ø est. 0.08. Th. 0.005-6. LM IIIA:2/B:1.
- 77-P 1706, *Pl. 171b:12*
Cup, rim frag. Clay: LW. Lugged rim. Ext. RB, zigzag and vertical band close to handle section. Rim Ø est. 0.13. Th. 0.003. LM IIIA:2.
- 77-P 1709, *Pls. 119, 171e:2*
Cooking jar, rim/neck frag. Clay: light red with grey core. Coarse fabric. High, straight rim. Rim Ø est. 0.13. Th. 0.004-7. Burnt. LM IIIA:2/B:1.
- 77-P 1710, *Pl. 171c:6*
Cup, handle. Clay: LW. A complete, vertical, strap handle. Int. RB. Ext. RB, bands along the edges of handle, a band around the handle section and three thin body bands. Handle 0.005 × 0.015. Th. 0.002-3. LM IIIA:2/B:1.
- 77-P 1711, *Pl. 171e:6*
Bowl, shallow, rim/body frag. Clay: LW. Plain ware. Everted rim. Rim Ø est. 0.20. Th. 0.004. LM IIIA:2/B:1.
- 77-P 1713, *Pls. 111, 171c:17*
Incense burner, body of container frag. Clay: LW. Part of lower body, base broken off. Ext. a wavy band and a base band. Ø est. 0.06. Th. 0.004-6. Base th. 0.002. LM IIIA:2/B:1.
- 77-P 1714, *Pl. 171e:5*
Kylix, rim frag. Clay: cream to light brown. Plain ware. Everted rim, a complete, high-slung, roll handle (loop-handled). Handle 0.010 × 0.013. Th. 0.004. LM IIIA:2.
- 77-P 1716, *Pl. 171c:16*
Stirrup jar, large, spout frag. Clay: light brown. A small knob below the rim. Ext. RB and neck band. Rim Ø est. 0.05. Th. 0.004-6. LM IIIA:2.

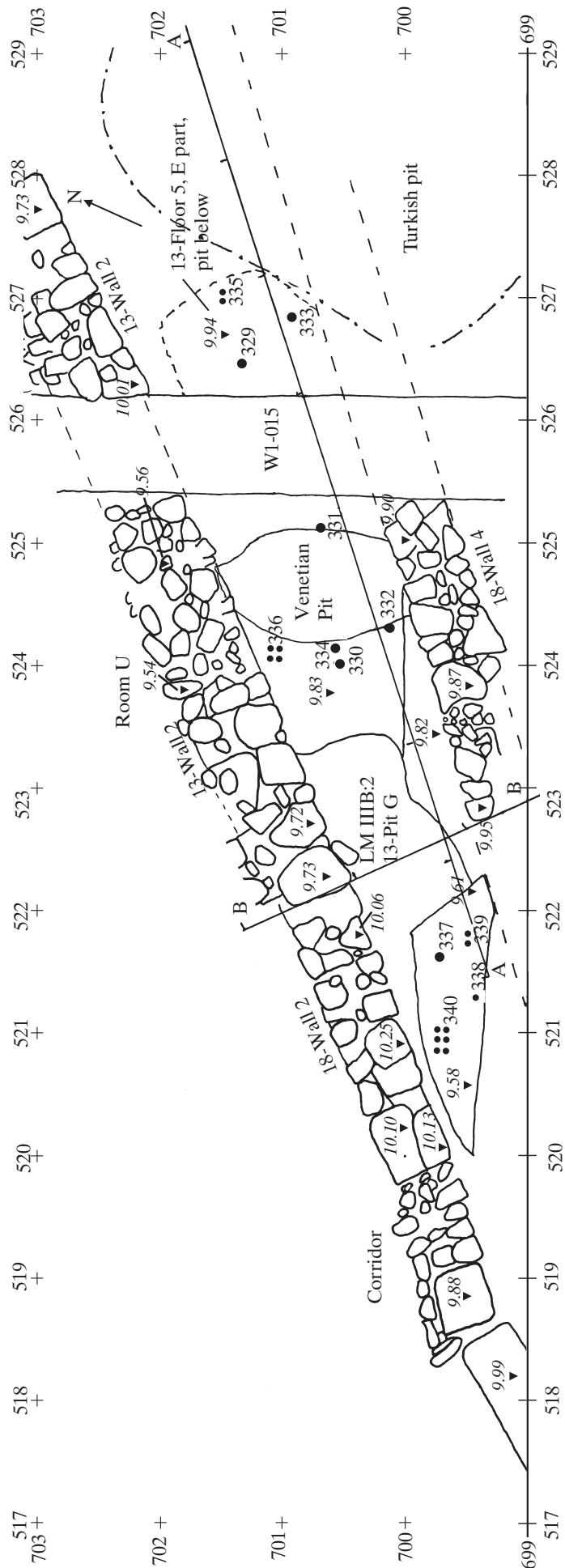

77-P 1721, *Pl. 171c:13*

Kylix, lower body/stem frg. Clay: LW. Solid stem. Int. a spiral. Ext. two bands on lower body, broad band on upper stem. Stem \varnothing 0.031 (not middle). Th. 0.007. LM IIIB:1.

77-P 1786, *Pls. 9I, 171c:4*

Cup, rim frg. Clay: LW. Everted rim. Int. RB. Ext. RB, shell chain framed by wavy bands and a body band. Rim \varnothing est. 0.14-15 (uneven). Th. 0.003. LM IIIA:2/B:1.

77-P 1794, outside j.

77-P 1803, *Pl. 171c:3*

Cup, rim frg. Clay: LW. Lugged rim. Int. RB. Ext. RB and panelled pattern: horiz. wavy bands framed by vertical bands. Th. 0.003. LM IIIA:2.

77-P 1810, *Pl. 171d:8*

Closed vessel, body frg. Clay: light grey. Yellow slip and red-brown paint. Ext. alternating hatched triangles, a broad body band framed by two thinner. Th. 0.006-8. LM IIIA:2/B:1.

77-P 1943, outside j.

77-P 1944 (+82-P 0134), *Pl. 171c:8*

Cup, body frgs. Clay: cream. Ext. alternating arcs. Th. 0.003. LM IIIA:2/B:1.

77-P 1945, *Pl. 171c:12*

Stirrup jar, small, spout frg. Clay: light reddish-brown. Int. RB. Ext. RB, a band on mid-neck and a neck band. A band around spout/handle section and curved bands. Spout \varnothing est. 0.027. Th. 0.004-5. LM IIIB:1.

77-P 1946, *Pl. 171c:11*

Closed vessel, body frg. Clay: light red to buff, hard, fine. Ext. four thin body bands and a broader further down on body. Th. 0.003-4. Myc IMP. LH IIIA:2/B:1.

77-P 1947, *Pl. 171e:3*

Closed vessel, body frg. Clay: light red to buff, hard, fine. Ext. scale pattern. Th. 0.004-5. Myc IMP. LH IIIA:2/B:1.

77-P 2112, *Pl. 216c:8*

Pithos, eight body frgs. Gravel-tempered fabric. Thick burnt slip ext. Four horiz. neighbouring rfb's with large finger impressions (1A). Th. 0.014-21. W of rfb 0.030. MpL 0.260. Joint to one large piece + another small piece. LM III.

77-P 2113, *Pls. 213, 215c:3*

Pithos, rim frg. Gravel-tempered fabric. Rounded ovoid, almost straight rim. Th. 0.080-25. Est. rim \varnothing 0.56. MpL 0.200. LM III.

77-P 2143, *Pls. 124, 172a:3*

Stand, body frg. Clay: red with thick grey core. Coarse fabric. Part of two round openings. \varnothing est. 0.26. Th. 0.015-20. LM IIIB:1.

82-P 1496, *Pl. 172a:2*

Bowl, shallow, large, rim frg. Clay: red. Plain ware. Everted rim, flat on top, a complete horiz. handle along rim. Rim \varnothing est. 0.35. Handle 0.013 x 0.017. Th. 0.004. LM IIIA:2/B:1.

82-P 1498, *Pl. 172a:1*

Closed vessel, body frg. Clay: light brown. Ext. a curved band and three body bands. Th. 0.006-9. Burnt int. LM IIIA:2/B:1.

82-P 1499, *Pl. 171d:10*

Closed vessel, body frg. Clay: light brown. Ext. below a band, filled connected hanging semicircles, a thin and a broad body band below. Th. 0.005-7. LM IIIA:2/B:1.

82-P 1524, *Pl. 171b:3*

Cup, base frg. Clay: LW. Flat base. Int. a spiral at base. Ext. base band and a thin band above. Base \varnothing est. 0.045. Th. 0.004-5. LM IIIB:1.

82-P 1525, *Pl. 171b:8*

Cup, rim frg. Clay: LW. Everted rim, scar from a vertical handle from rim. Int. RB. Ext. RB, hatched lozenges? framed by wavy bands. Th. 0.003-4. LM IIIA:2/B:1.

Intrusive sherds

77-P 0456 (see *GSE I, 78*).

77-P 1847 (see *GSE I, 78*).

Fig. 51. LM IIIB:1 Street, plan with distribution of finds.

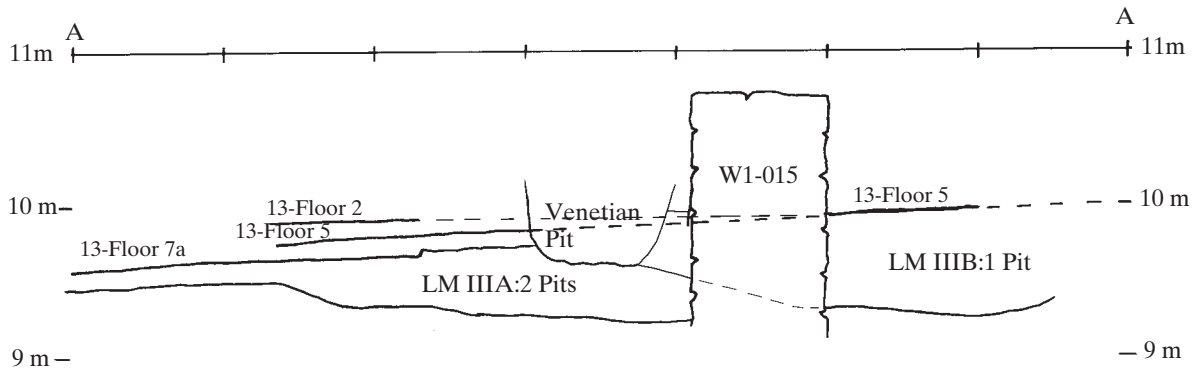

Fig. 52a. Street, section A-A; cf. Fig. 51.

LM I

82-P 1495, **Closed vessel**; 82-P 1497, **Jar**; 82-P 1644, **Open vessel**.

Outside joins

77-P 0298 to 77-P 1603, *GSE I*, 167.77-P 0301 to 82-P 0171, *GSE I*, 108.77-P 0303 to 77-P 1618, *GSE III*, 122.

77-P 0388 to 71-P 0388, north of Buildings 1 & 2, north of Room H, p. 192.

77-P 1669 to 82-P 0706, Building 3, 18-Pit F, p. 116.

77-P 1794 to 82-P 0376, LM IIIA:2, Rubbish Area Southeast, 13-Pit K, II, p. 222.

77-P 1943 to 84-P 1064, LM IIIA:2, Rubbish Area Southeast, 20-Pit K/N, p. 232.

77-P 1944 to 82-P 0134, *GSE I*, 106.82-P 1605 to 77-P 0184, *GSE I*, 83.77-P 0345, *GSE I*, 203.

SMALL FINDS

77-M 045, *Pl. 244g:1*, 525.1/700.7/9.26 [331]

Bronze, frg. Green corrosion with grey veins. Two frgs. of bronze pin/pins or the like. Longest frg. L 0.028. Ø 0.002. Shortest frg. L 0.023. Ø 0.001.

77-M 046, *Pls. 221, 244g:2*, 524.3/700.15/9.29 [332]

Bronze pendant. Of a flat axe-shape with loop pres. Corroded and cracked. L 0.046. Th. 0.005.

77-TC 110, *Pls. 218, 244g:3* [333]

Figurine, possibly a figurine of the Hollow Psi-type. Upper part of hollow body. Frg. condition. Start of one arm pres. Reddish-brown clay, hard with some grits. Light brown slip. Reddish-brown paint, lustrous, worn and flaking. Horiz. bands framed by vertical lines. H 0.033. W 0.044. Th. of wall 0.007.

77-S 019, *Pl. 244g:4*, 524.2/700.5/9.31 [334]

Rock crystal, frg. Part of rock crystal worked into a prism-shape. Underside is rough and does not seem to have been worked. H 0.041. Ø at base 0.025. Cf. 77-S 018, above p. 118.

OBSIDIAN

77-OB 036a, **Platform rejuvenation flake**, *Pl. 268c:7* [335]; 77-OB 036b, **Debris or waste by-product of core reduction** [335]; 77-OB 082a, **Blade** [336]; 77-OB 082b, **Platform rejuvenation flake**, *Pl. 268c:6* [336]; 77-OB 082c, **Blade** [336]; 77-OB 082d, **Bladelet** [336].

BONES

84 fragments identified from young and adult *Ovis*, *Capra*, *Ovis/Capra*, *Sus*, *Bos*, and *Dama*; further from adult *Cervus* and 1 *ulna* supposedly from adult *Bos primigenius*.

SHELLS

3 *Spondylus* – upper, L 0.078, W 0.066, hinge 0.037, fresh, has spines; (2 among bones). 1 *Glycymeris* – left, very water-worn, W 0.049, H 0.045, hole W 0.008, H 0.005. 1 *Pinna* – frg., 0.063 × 0.0355.

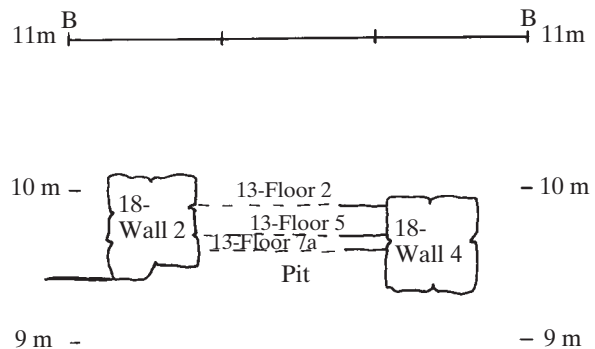

Fig. 52b. Street, section B-B; cf. Fig. 51.

Comments: The two intrusive sherds derive from an area where the Turkish Pits 2-4 (*GSE I*, 105-109) had probably not been cleaned well enough. Most joins here can be naturally explained by later activities.

In lower layer (*Figs. 51, 52a-b, Pls. 16c:27, 55c-e, 56a*)

13-Floor 7a was identified in the western part of the street up to c. 524.2, east and northwest of which the rubbish pit had cut through the floor. The surface of the floor is grey, beaten earth floor containing sherds, bones, charcoal and many small pebbles; very sandy. The floor is 0.03-0.06 thick and sloping from east to west. It was excavated at levels 9.72/9.58 to 9.45/9.44. Below the floor was light brown to grey and red-brown soil, and it was found only in the western part below the floor up to 522.3, while in the eastern part we had a continuation of the pit which cut the original floor. In the floor both LM IIIA and B were noted with a few earlier pieces, while below the floor mainly LM IIIA was noted. 7.200 kg of pottery were collected: 13% decorated, 73% kept and 1.4% inventoried. Shapes were not counted.

POTTERY

82-P 1487, *Pl. 172b:4*

Closed vessel, body frg. Clay: cream to light brown. Ext. zigzag? framed by two vertical bands. Th. 0.004-5. LM IIIA:2/B:1.

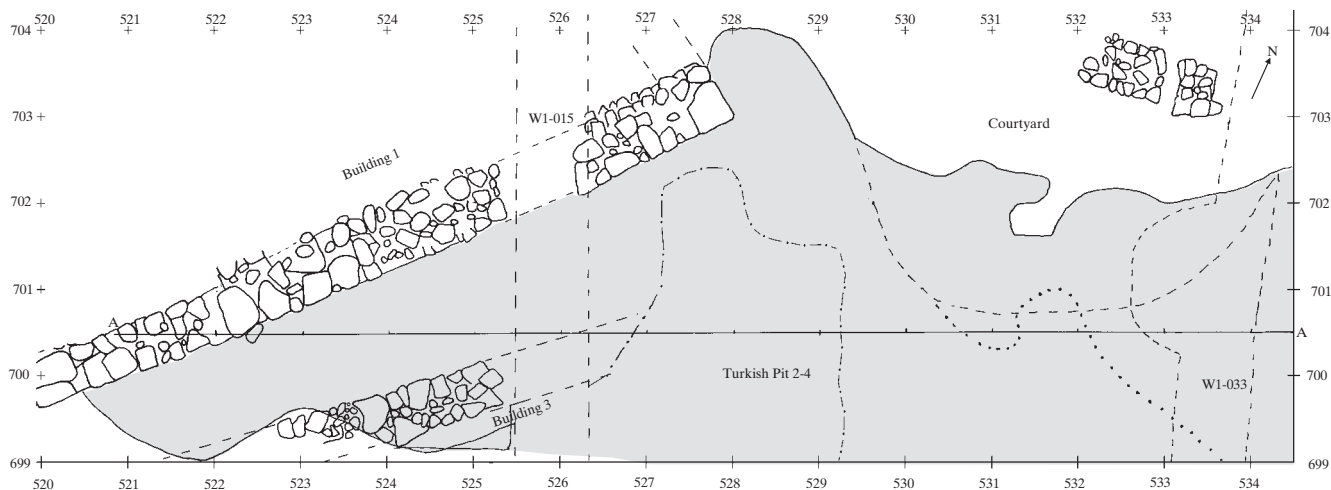

Fig. 53. LM IIIB:1 Street and Rubbish Area Southeast, plan. Reproduced 57% of original in 1:50.

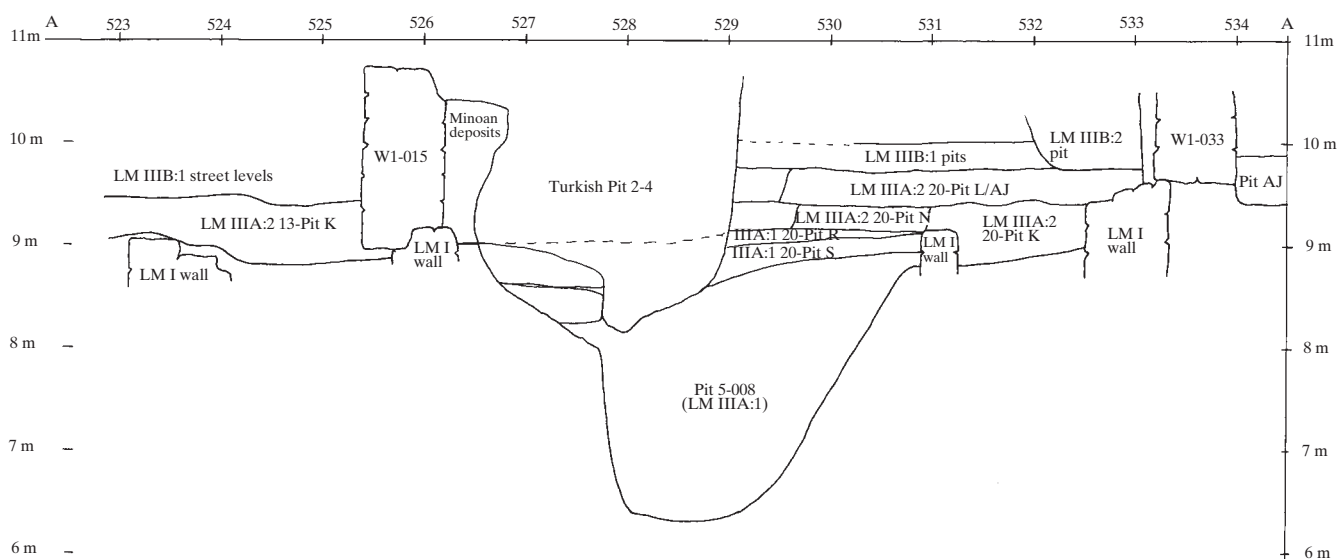

Fig. 54. Street and Rubbish Area Southeast, section A-A; cf. Fig. 53. Reproduced 67% of original in 1:50.

82-P 1488, *Pl. 172b:1*

Cup, body frg. Clay: light brown. Int. a band close to base. Ext. three even body bands. Th. 0.003-4. LM IIIA:2/B:1.

82-P 1489, *Pl. 172b:7*

Krater, handle frg. Clay: LW. Part of a horiz., roll handle. Ext. band along edges and on mid-handle, barred on top, a band around attachment. Handle 0.013 × 0.016. Th. 0.004-5. Misfired. LM IIIA:2/B:1.

82-P 1490, *Pl. 172b:3*

Cup, body frg. Clay: LW. Ext. hatched lozenges framed by wavy bands. Th. 0.003. LM IIIA:2/B:1.

82-P 1491, *Pl. 172b:2*

Cup, rim frg. Clay: LW. Everted rim. Int. RB. Ext. RB and alternating arcs. Th. 0.003-4. LM IIIA:2/B:1.

82-P 1790, *Pl. 172b:5*

Cup, body frg. Clay: LW. Ext. vertical zigzag and a body band. Th. 0.003. LM IIIA:2/B:1.

82-P 1791, *Pl. 172b:6*

Cup, body frg. Clay: LW. Int. sponge pattern. Ext. shells? Th. 0.003. LM IIIA:2.

SMALL FINDS

82-M 004, *Pl. 244f*, 533.56/708.00/10.17 [337]

Bronze, frg. Corroded. Two wires of bronze fastened together. One of wires is thicker and has a straight profile. Other wire is thinner

and is bent in middle, while its ends are straight. Around wires there are traces of organic fibres (grass, reeds or the like), which has held the two wires together. L. 0.025. W. 0.014.

OBSIDIAN

82-OB 001, **Blade** [338]; 82-OB 013a, **Flake of core's shaping** [339]; 82-OB 013b, **Sickle element on blade**, *Pl. 266* [339]; 82-OB 013c, **Crested bladelet** [339]; 82-OB 013d, **Debris or waste by-product of core reduction** [339]; 82-OB 013e, **Blade** [339]; 82-OB 013f, **Bladelet** [339]; 82-OB 018a, **Flake of core's reduction** [340]; 82-OB 018b, **Chip of core's reduction** [340].

BONES

Few fragments from adult *Ovis*, *Capra*, *Ovis/Capra*, and *Sus*.

SHELLS

1 *Glycymeris* – water-worn, small.

Comments: The sherds in and below this floor seem to indicate that the original street level like the neighbouring walls must have been constructed at the very beginning of IIIB:1.